

# THE RIDGE WEDDING ROOM LAYOUTS

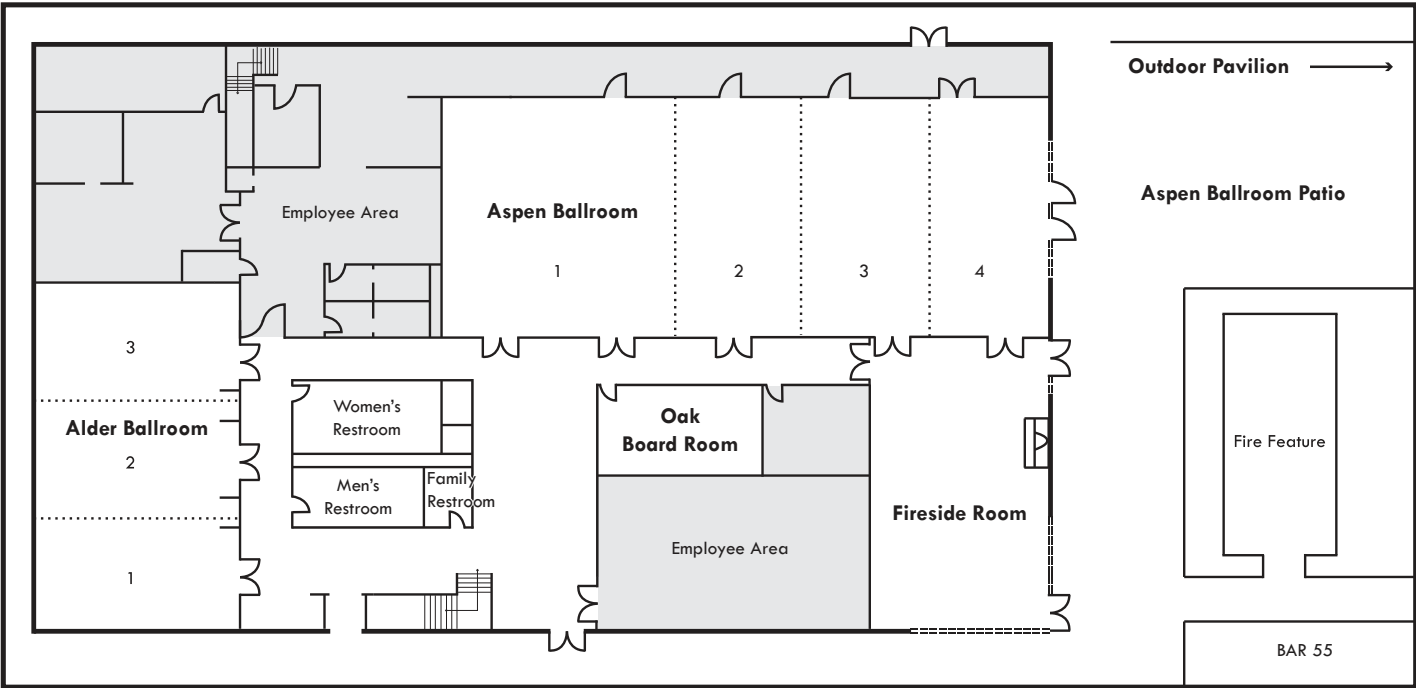

BAR 55 and Fire Feature open to the public.

## CEREMONY SITE

Below room capacities are based on theater style seating.

Outdoor Pavilion	300
------------------	-----

## COCKTAIL HOUR

Below room capacities are based on cocktail tables and minimal seating.

	DIMENSIONS	SQUARE FT.	CEILING	CAPACITY
Aspen Ballroom Patio	ask your coordinator for more details			
Fireside Room	49' x 41'	2,009	10'	150

## RECEPTION

Below room capacities include space for a DJ and dance floor.

	DIMENSIONS	SQUARE FT.	CEILING	CAPACITY	WITH TABLES ON DANCE FLOOR
Aspen Ballroom	40' x 103'	4,120	12'	270	300
Fireside Room	49' x 41'	2,009	10'	100	120
Alder Ballroom	34' X 58'	1,972	10'	80	100